



**12 Stoneham Street  
Joondanna, WA**



3



2



2

## Cottage Charm

Now SOLD by Openn Negotiation (flexible conditions online auction).

The Openn Negotiation has ended with the property exceeding Reserve..

Contact the sales agent immediately to learn more about Openn Negotiation

Open to all buyers, including conditional on finance, subject to seller approval.

There's so much to love about this charming Circa 1948 cottage. Complete with quintessential white Pickett fences, verandah and character features, its all here!

Recent renovations incorporate a stunning master ensuite bathroom with timeless Carrara tiling and brushed gold plumbing fixtures. The upgraded kitchen is complete with white Engineered Stone tops and brand new stainless steel appliances.

Of course all of the character features you would expect including wide Jarrah floor boards, high ceilings, fireplace with gas connection plus modern conveniences including air conditioning, double garage, security alarm and so much more.

All of this on a generous 445m2 corner lot with front and rear courtyards and located right on the Mt Hawthorn border.

If schools are important, you'll be pleased to note that this amazing home is also

located within the new Bob Hawke College intake area.

**PRICE GUIDE:** \$895,000.00  
Area: 445 m2  
Council Rates: \$1,798.50 p.q.  
Water Rates: \$1,294.49 p.q.

---



**Rob Stefanovski**  
+61 417 928 888



**Anna Stefanovski**  
0417 928 888

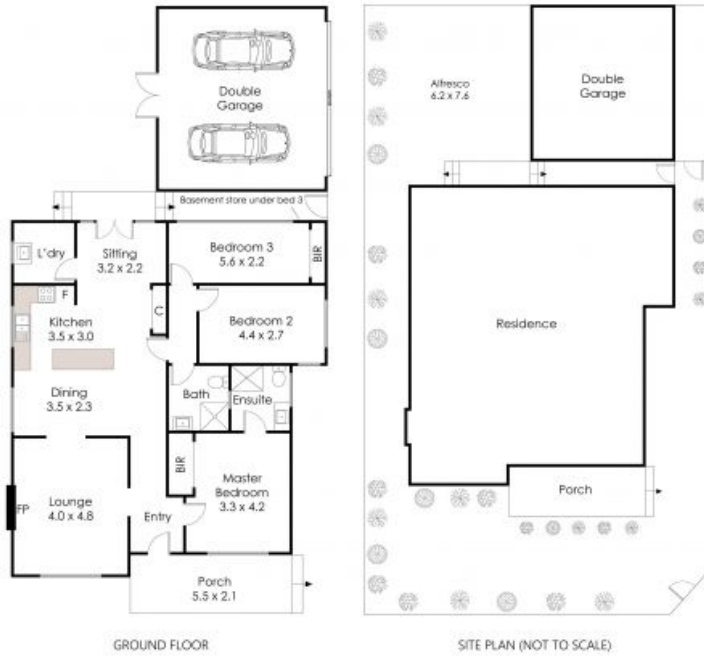

12 Stoneham Street, Joondanna

This floor plan is not to scale.  
 Dimensions are approximate and therefore should only be used for illustrative purposes.

-  445m<sup>2</sup>
-  3 Bed
-  2 Bath
-  2 Car